



Datasheet

solids - Blow Through Rotary Valve

DBS-Basic



Operating conditions:

Permissible operating pressure: <1.5 bar g

Max. temperature: 150° C

Bulk solids data:

Particle size: Powdered, up to medium hardness,

Fluidity: from good up to difficult fluidity

Type	Inlet / Outlet	Height	V / Revolution	Weight
DBS1706B01A	Ø 175 / Ø 65 mm	335 mm	6 dm ³	125 Kg
DBS2011B01A	Ø 200 / Ø 80 mm	400 mm	11 dm ³	175 kg
DBS2520B01A	Ø 250 / Ø 100 mm	465 mm	20 dm ³	230 Kg
DBS3034B01A*	Ø 300 / Ø 125mm	560 mm	34 dm ³	400 Kg

* Zone 21 according to ATEX 2014/34/EU

Basical version:

Housing: cast iron GG25

Rotor: welded steel construction - stainless steel 1.4306 (DIN) / 304L (AISI)

9 pockets, rigid blades

External bearing

Shaft seal: radial shaft sealing rings with sealing/purge air connection

suitable for zone 20 inside and protective system category 1 acc. ATEX 2014/34/EU with type examination test by a notified body

drive: direct

motor: three-phase gearboxmotor

manufacturer: SEW, separately specified

form: slip on gear with torque arm

Surface treatment:

sand blasted

primer 40 µm of zinc phosphate, painted with 40 µm of 2-component polyurethane, blue RAL5012

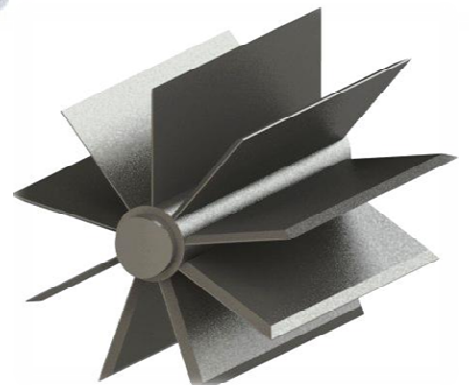
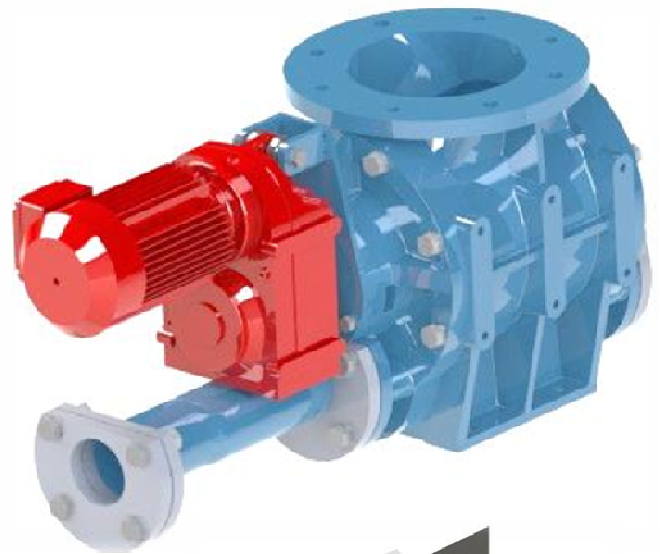

approval:	MIGSA	SST	H. Linder	
Date:	Sign:	Date:	Sign:	Date:
		11.3.13	Le	11.3.13
				Li

Preliminary modifications reserved



solids solutions group
www.solids.eu





Datasheet

solids - Blow Through Rotary Valve

DBS-Basic



Options:

1. Rotor with bars made of round steel between the chambers

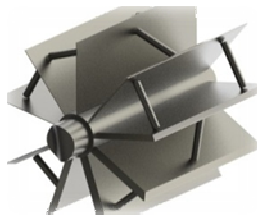

2. Rotor with reduced volume, about half of the standard volume

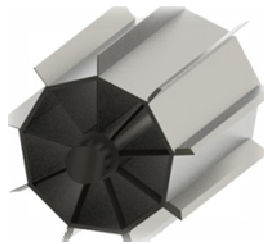

3. ---

4. With leakage air collector made of carbon steel

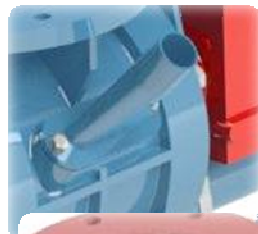

5. Inlet for granulates, grain size $>500 \mu\text{m}$, cubic up to 10 mm, made of carbon steel



6. Leakage air collector with granule inlet, made of carbon steel

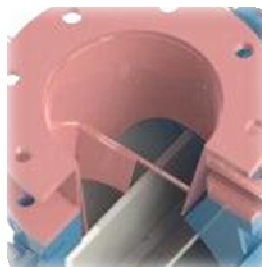

7. Leakage air collector for non-granules, made of carbon steel

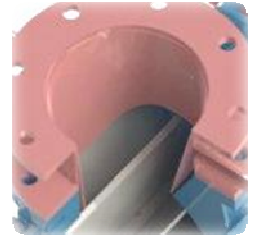

8. With M12 inductive turning detector



9. Pneumatic installation for sealing/purge air, consisting of 2/2-way solenoid valve, pressure regulator and nozzles

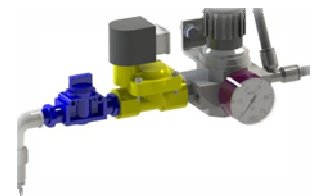

10. Shock pressure proof 10 bar, flame propagation proof and Protection system according to ATEX 2014/34/EU Category 1, with water pressure test, including leakage air collector and granulates inlet

11. Rotor with 10 blades

Related documents:

3D-Part: Type.step (example: **DBS1706B01**. Step)

2D-planning drawing: Type.dxf (example: **DBS1706B01**. dxf)

selection criteria: SG-ZRS-SRV-DBS

Pricelist: PL-DBS-Basic



solids solutions group
www.solids.eu

